

# Conor's Pass Subdivision Phase 1 Newark, Ohio *\*Preliminary\**

*\*This drawing is for illustrative purposes only. Features of the actual site development, including location and configuration of lots, lot numbers, easements and reserves may vary from the representation hereon and such variations may be significant.*

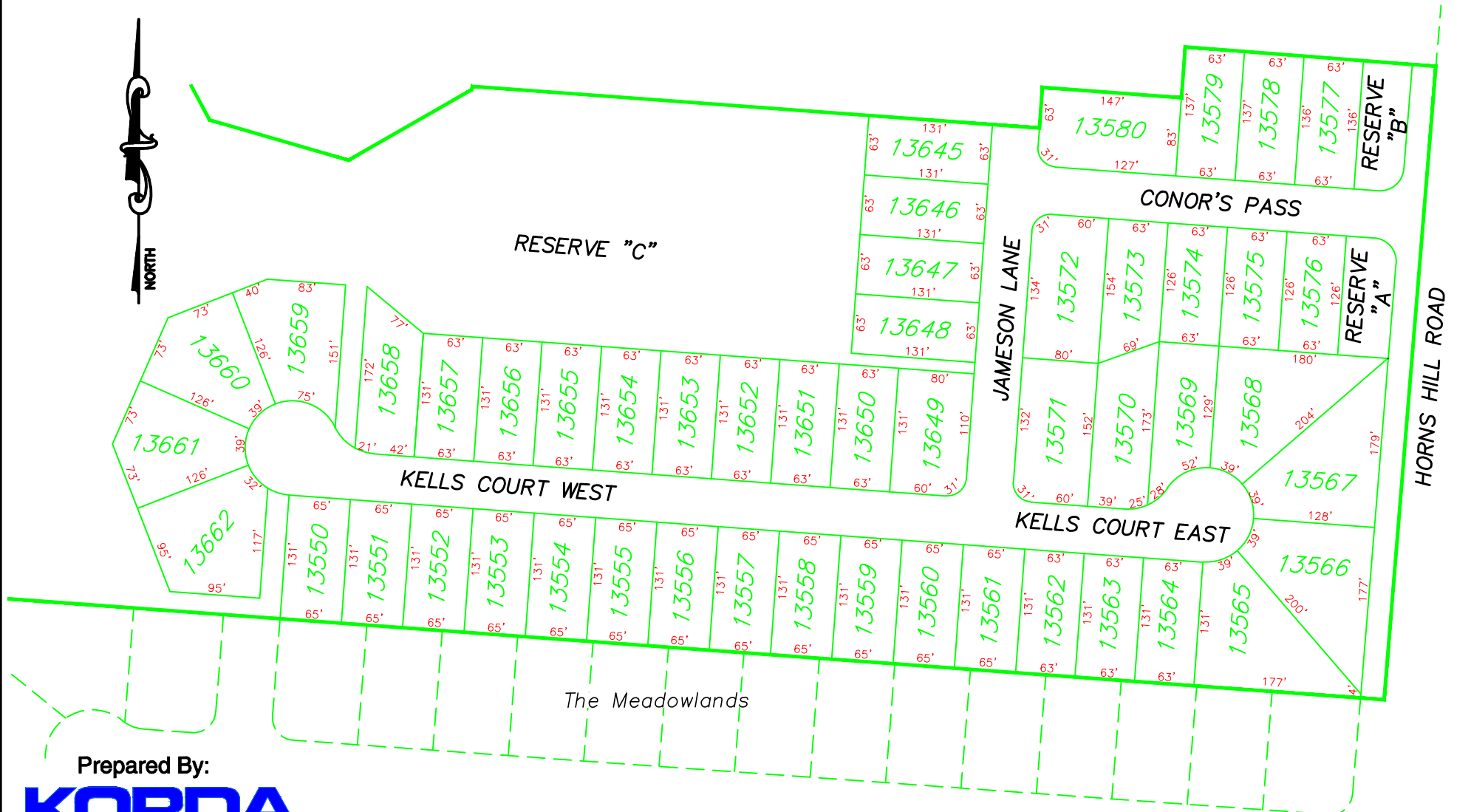

Prepared By:



Korda/Nemeth Engineering, Inc - Consulting Engineers  
1650 Watermark Drive, Suite 200 - Columbus, Ohio 43215-7010  
TEL 614-487-1650