

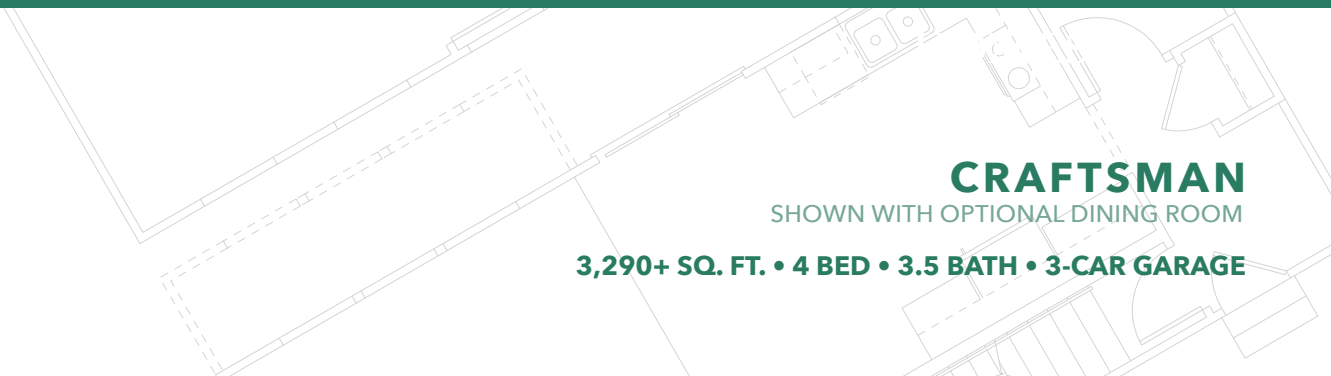

# The Cedar

TWO STORY FLOOR PLAN

**CRAFTSMAN**  
SHOWN WITH OPTIONAL DINING ROOM  
**3,290+ SQ. FT. • 4 BED • 3.5 BATH • 3-CAR GARAGE**



# The Cedar

TWO STORY FLOOR PLAN



OPTIONAL 2' GREAT ROOM EXTENSION



OPTIONAL 4' GREAT ROOM EXTENSION

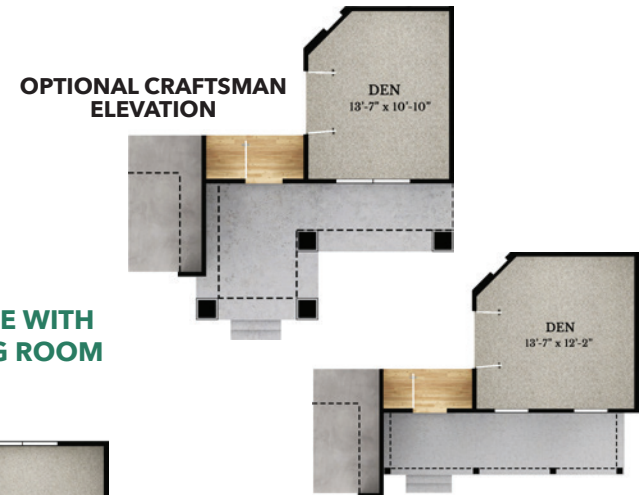

OPTIONAL CRAFTSMAN ELEVATION

FIRST FLOOR BASE WITH 3-CAR GARAGE

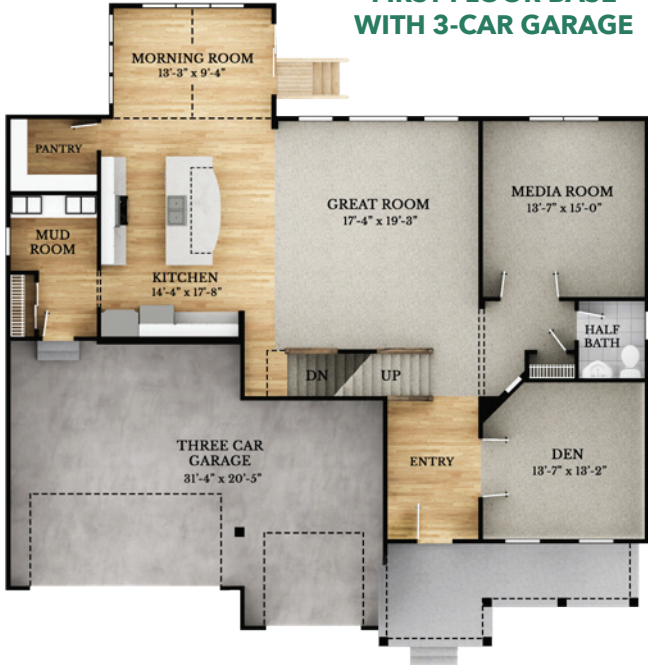

FIRST FLOOR BASE WITH OPTIONAL DINING ROOM



OPTIONAL AMERICAN FARMHOUSE ELEVATION



OPTIONAL TWO CAR SIDE LOAD GARAGE



OPTIONAL HALF BATH WITH GUEST SUITE



OPTIONAL 6' 2 CAR GARAGE EXTENSION



OPTIONAL 2' 2 CAR GARAGE EXTENSION



OPTIONAL 4' 2 CAR GARAGE EXTENSION



OPTIONAL THREE CAR GARAGE



OPTIONAL GUEST SUITE

OPTIONAL CARRIAGE GARAGE

3,290+ SQ. FT. • 4 BED • 3.5 BATH • 3-CAR GARAGE

# The Cedar

TWO STORY FLOOR PLAN

## SECOND FLOOR BASE



OPTIONAL DROP-IN SOAK TUB



OPTIONAL FREE-STANDING TUB

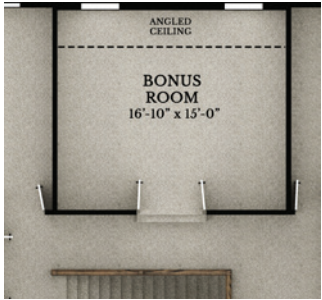

OPTIONAL BONUS ROOM



OPTIONAL OWNER'S BEDROOM SITTING AREA



OPTIONAL AMERICAN FARMHOUSE ELEVATION



OPTIONAL CRAFTSMAN ELEVATION

3,290+ SQ. FT. • 4 BED • 3.5 BATH • 3-CAR GARAGE

# The Cedar

ADDITIONAL EXTERIOR DESIGNS



**AMERICAN CLASSIC**  
Shown with standard 3-Car Garage



**AMERICAN CLASSIC**  
Shown with optional Dining Room



**CRAFTSMAN**  
Shown with standard 3-Car Garage



**AMERICAN FARMHOUSE**  
Shown with standard 3-Car Garage



**AMERICAN FARMHOUSE**  
Shown with optional Dining Room

